

LED LINKABLE SHOP LIGHT

SPS-2FT-18W-XXK | SPS-3FT-27W-XXK | SPS-4FT-36W-XXK

DESCRIPTION

4FT Led Shop Light | High Standard Switch | Linkable | Plug and Play



CONSTRUCTION

Polycarbonate

ELECTRICAL

Available as 108-132V input.

INSTALLATION

Surface Mounting or Suspension Mounting

EASY ON/OFF CONTROL

These led shop lights come with an on/off switch that allows you to turn them on and off with ease. This makes it easy to control the lighting, without the need for complicated wiring or switches

LINKABLE

These can link together. 4FT: up to 4 lights.

APPLICATIONS

garage/workbench/basement/utility room/raft room or repair shop. Suitable for dry and damp indoor locations. Working temperature -4°F to 104°F (-20°C to 40°C).

WARRANTY

5 Years Limited Warranty, Rated for 50,000 hours.

FEATURES

Size	2FT 3FT 4FT
Wattage	18W 27W 36W
CCT	2700-6500K
Efficiency	100lm/W
Lumens	1800lm 2700lm 3600lm
Beam Angle	220°
Input Voltage	108-132V AC
Frequency Range	50/60Hz
CRI	>80
PF	>0.5
THD	<=20%
Lifetime	50,000 hours
Operating Temperature	-4°F to 104°F (-20°C to 40°C)

ORDERING INFORMATION

Model	Lenght	Wattage	Voltage	Lumens	Efficacy	CCT	Dimensions
SPS-2FT-18W-XXK	2FT	18W	108-132V	1800lm	100lm/W	2700-6500K	22.64"L x 2.87"W x 1.26"H
SPS-3FT-27W-XXK	3FT	27W	108-132V	2700lm	100lm/W	2700-6500K	33.96"L x 2.87"W x 1.26"H
SPS-4FT-36W-XXK	4FT	36W	108-132V	3600lm	100lm/W	2700-6500K	45.28"L x 2.87"W x 1.26"H

PHYSICAL SPECIFICATIONS

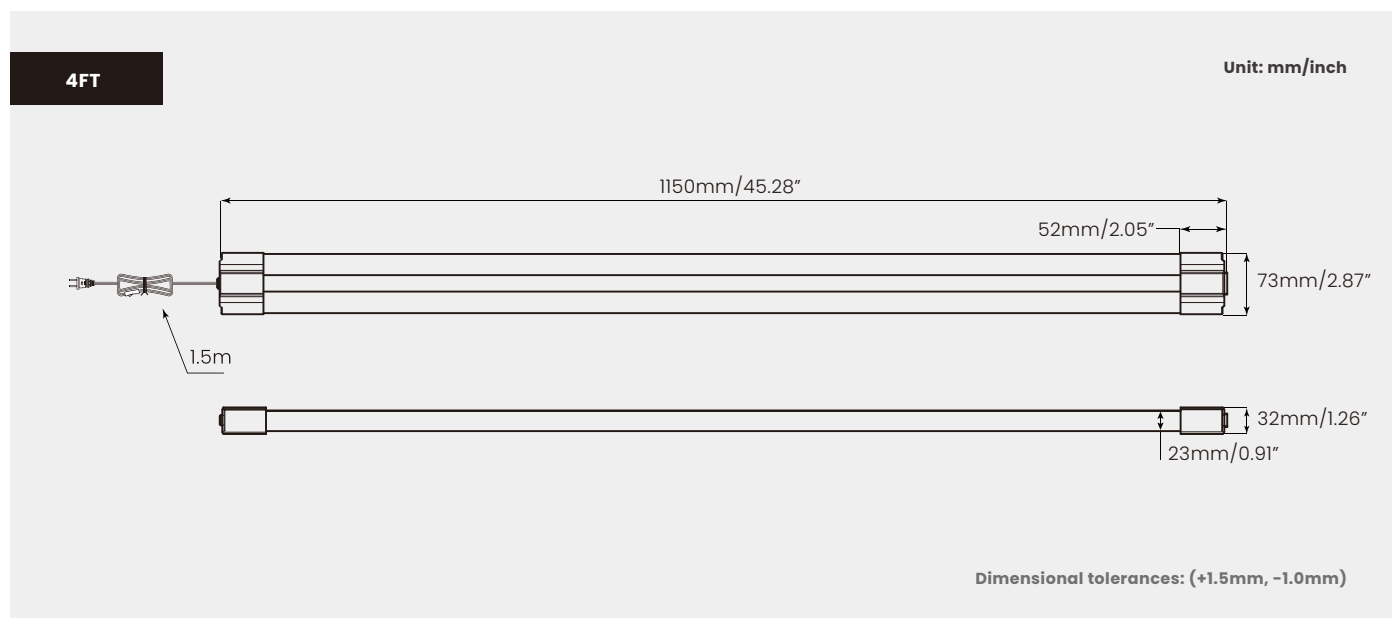

OPTIONS

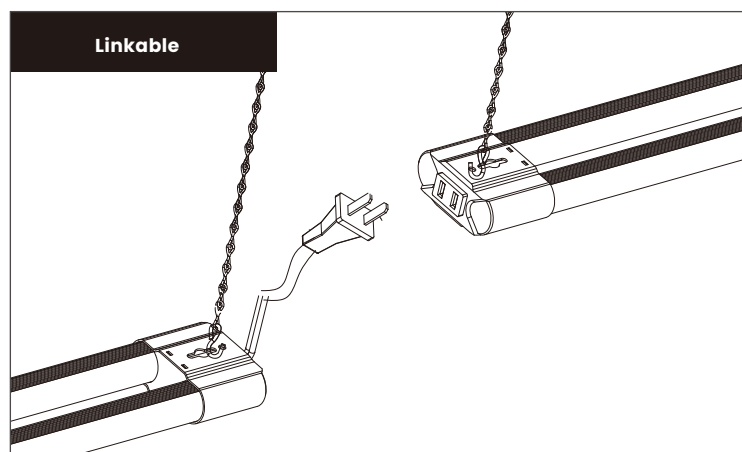

NOTE: MAX. 4 UNITS LINKABLE.

THIS FIXTURE IS INTENDED TO BE ONLY INSTALLED DIRECTLY BENEATH A CEILING-MOUNTED RECEPTACLE.